

Fast Recovery Rectifier

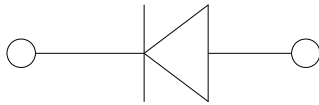
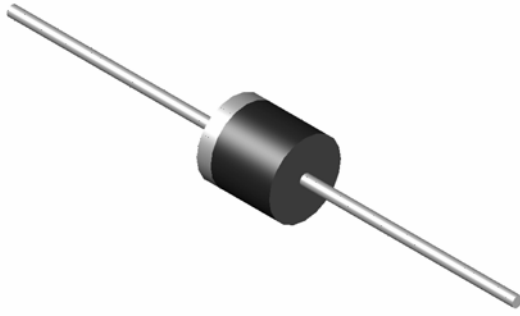

Features

- High efficiency
- High current capability
- High reliability
- High surge current capability
- Low power loss
- Glass passivated chip junction
- Solder dip 275 °C max. 7 s, per JESD 22-B106

Mechanical Data

Package: R-6

Molding compound meets UL 94 V-0 flammability rating,
RoHS-compliant

Terminals: Tin plated leads, solderable per J-STD-002 and JESD22-B102

Polarity: Color band denotes cathode end

Maximum Ratings (Ta=25 Unless otherwise specified)

PARAMETER	SYMBOL	UNIT	FR601	FR602	FR603	FR604	FR605	FR606	FR607	
Device marking code			FR601	FR602	FR603	FR604	FR605	FR606	FR607	
Maximum Repetitive Peak Reverse Voltage	VRRM	V	50	100	200	400	600	800	1000	
Maximum RMS Voltage	VRMS	V	35	70	140	280	420	560	700	
Maximum DC blocking Voltage	VDC	V	50	100	200	400	600	800	1000	
Average Forward Current @60Hz sine wave, Resistance load, Ta=65	IF(AV)	A	6.0							
Forward Surge Current (Non-repetitive) @60Hz Half-sine wave, 1 cycle, Tj=25	IFSM	A	200							
Forward Surge Current (Non-repetitive) @1ms, square wave, 1 cycle, Tj=25			400							
Current squared time @1ms t 8.3ms Tj=25 Rating of per diode	I²t	A²s	166							
Typical junction capacitance @Measured at 1MHz and Applied Reverse Voltage of 4.0 V.D.C	Cj	pF	70				56			
Storage Temperature	Tstg		-55 ~ +150							
Junction Temperature	Tj		-55 ~ +150							

Electrical Characteristics Ta=25 Unless otherwise specified

PARAMETER	SYMBOL	UNIT	TEST CONDITIONS	FR601	FR602	FR603	FR604	FR605	FR606	FR607
Maximum instantaneous forward voltage drop per diode	VF	V	IFM=6.0A	1.3						
Maximum DC reverse current at rated DC blocking voltage per diode	IR	µA	Tj=25	2.5						
			Tj=125	100						
Maximum reverse recovery time	tr	ns	IF=0.5A, IR=1.0A, IIR=0.25A	150			250	500		

)5 7+58)5

v7KHUPDO &KDUDÄ7HULVWLFV

FIG.5: Diagram of circuit and Testing wave form of reverse recovery time

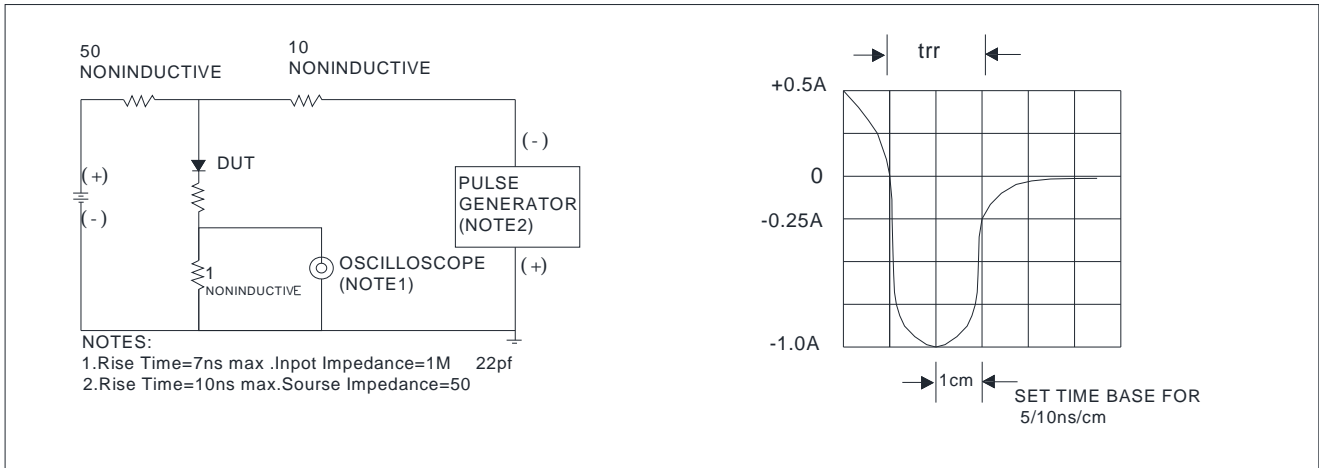

Outline Dimensions

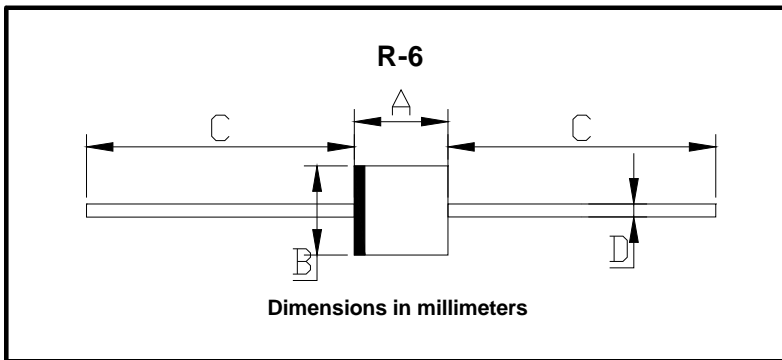

R-6		
Dim	Min	Max
A	8.60	9.10
B	8.60	9.10
C	25.4	/
D	1.20	1.32

